

University of Durham Map and Information for Visitors

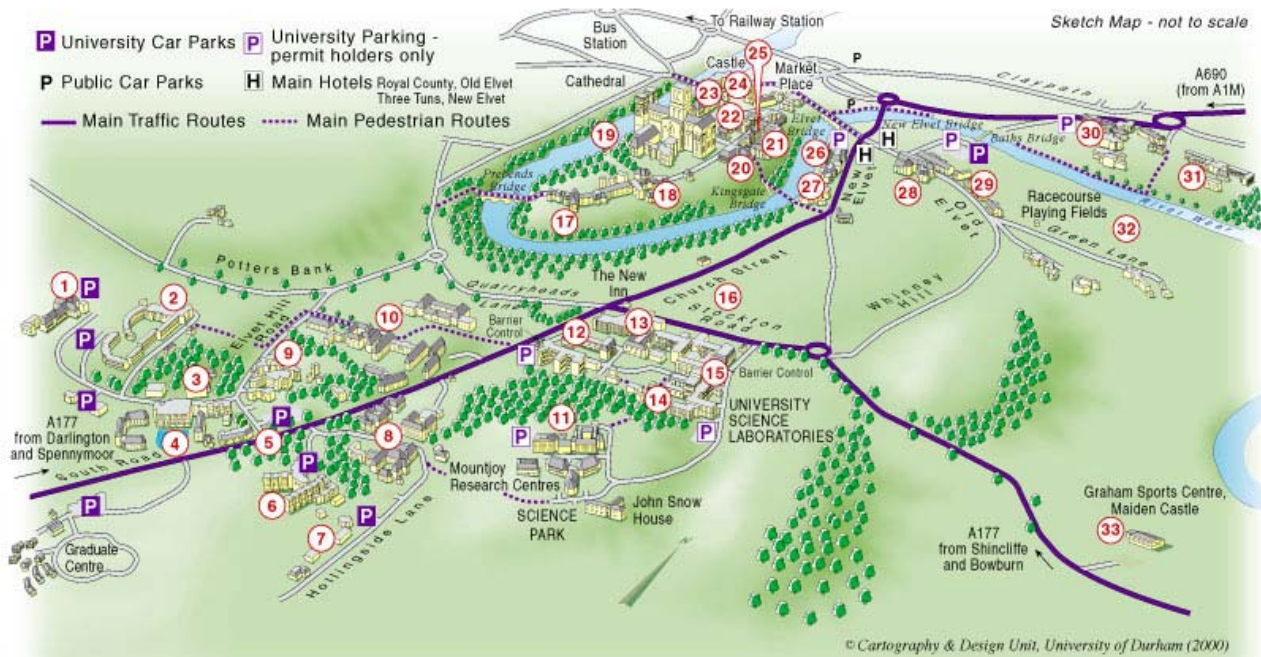

Numerical List

- | | |
|---------------------------------------------------------------------------------------------------------------------------------------------------------------------------------------------|-----------------------------------------------------------------------------------------------------------------------------------------------------------------------------------------------|
| 1 Business School | 18 St John's College |
| 2 St Aidan's College , including Lindisfarne Conference Centre | 19 Old Fulling Mill Museum of Archaeology |
| 3 East Asian Studies and Oriental Museum ; Lafcadio Hearn Centre , Teikyo University | 20 St Chad's College |
| 4 Van Mildert College and Conference Centre | 21 Hatfield College |
| 5 House of Sport | 22 Theology ; Pemberton Lecture Rooms |
| 6 Collingwood College & Conference Suite | 23 Music ; Palace Green Library ; Archives and Special Collections |
| 7 Botanic Garden | 24 University College, Castle |
| 8 Grey College & Holgate Suite , incl Fountains Hall | 25 History ; Law ; Classics ; Assembly Rooms |
| 9 Trevelyan College & Sir James Knott Hall ; Institute for Middle Eastern & Islamic Studies | 26 Elvet Riverside, including: Modern European Languages Applied Social Studies |
| 10 St Mary's College | 27 Dunelm House (DSU) , including Careers Advisory Service |
| 11 Biological and Biomedical Sciences ; Psychology | 28 University Office (University administration) |
| 12 Physics , including the Ogen Centre for Fundamental Physics; Geography | 29 Philosophy ; Politics ; Anthropology ; Sociology ; Economics & Finance ; Health Centre |
| 13 Main Library ; Archaeology & Dawson Building | 30 School of Education ; University Day Nursery ; Pelaw House, including Service for Students with Disabilities |
| 14 Engineering ; Computer Science ; Earth Sciences ; | 31 College of St Hild and St Bede ; Caedmon Hall (Hild/Bede) |
| 15 Chemistry ; Mathematical Sciences ; IT Service ; Security Office and Out of Hours enquiry post; Health and Safety Office | 32 Estates and Buildings ; Racecourse playing fields |
| 17 St Cuthbert's Society | 33 Gaham Sports Centre |